

# Wall-mounted non-return air exhaust vent with drip cap

## USUA



### Description

USUA air exhaust vent are made entirely from stainless steel sheet product and designed for use in home ventilation systems. The inverted hopper drip cap protects against the ingress of melt and rain water and the non-return valve in the vent prevents air back flow. The air exhaust vent is installed with screws. The inward sleeve fits round spiral ducts and flexible ducts.

**Available materials — Product code examples**  
USUA -...- stainless steel sheet

**Product code example**  
Product code: **USUA - aaa**

type	
Ød	

### Dimensions

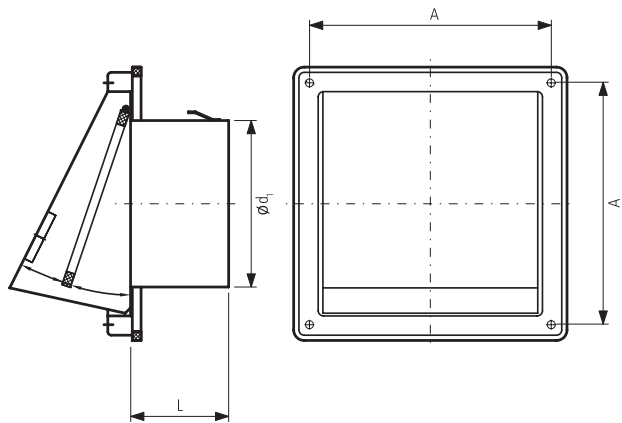

Product code	Ød <sub>1</sub> (mm)	A x A (mm)	L (mm)	Air flow rate (cm <sup>2</sup> )
USUA-100	100	137x137	52	71
USUA-125	125	167x167	52	113
USUA-150	150	167x167	62	165